

FEATURES



Auto Lubrication System

The auto lubrication system with default monitor ensures high reliable operation.



HMI Interface

User-friendly design for simple and easy operation.

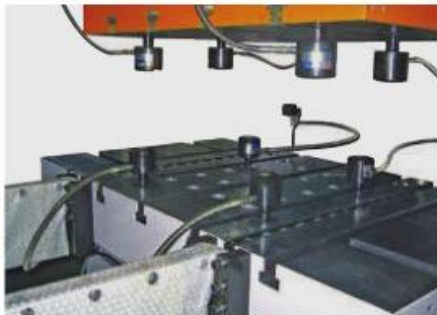

Quick Die Change Device (Option)

The die lifter, die clamp and auxiliary rails allow to carry out die changing easily in a short time.

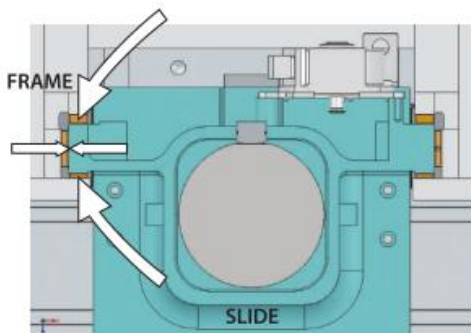

Long 6-Side Gibs

Durable alloy brone lining fixed directly on the frame without the defect of losing adjusting bolts. Durable lining can also maintain high accuracy and extend the life of tooling.

Model	SN1-25				SN1-35				SN1-45				SN1-60				SN1-80				SN1-110				SN1-160				SN1-200				SN1-250																			
	S	H	P		S	H	P		S	H	P		S	H	P		S	H	P		S	H	P		S	H	P		S	H	P		S	H	P																	
Capacity	250				350				450				600				800				1100				1600				2000				2500																			
Stroke Length (D)	80	50	35	90	60	40	110	70	45	130	80	50	150	100	60	180	110	70	200	130	80	220	150	90	250	180	100	250	180	100	250	180	100	250	180	100																
Stroke per Minute	90				80				70				60				50				40				30				25																							
Tonnage Rating Point	3.2				3.2				3.2				4				5				6				6				6																							
Die Height (D.H)	230	200	200	250	220	220	270	240	240	300	270	330	300	300	300	350	320	320	400	360	360	450	400	400	400	400	400	450	400	450	400	450																				
Slide Adjustment (G)	50				60				70				80				90				100				110				120																							
Slide Area (PxQ)	330x250				380x300				430x350				480x400				560x460				650x520				720x580				860x650				960x720																			
Diameter of Shank Hole	ø38.1				ø50.8				ø50.8				ø50.8				ø50.8				ø65				ø65				ø65																							
Bolster Area (ExF)	700x320				780x400				840x440				900x520				1050x600				1150x680				1250x760				1400x840				1500x900																			
Bolster Thickness (T)	85				100				115				130				140				155				165				180				180																			
Bolster Height (Z)	800				800				800				900				900				900				900				1000				1000																			
Frame - Inside Distance (R)	388				486				516				544				614				670				730				900				970																			
Frame - Gap Distance (K)	170				210				230				270				310				350				390				430				460																			
P.T.O. Shaft Position (C'xG'd)	351x983x383				403x1068x405				428x1158x437				450x1285x478				507x1445x512				596x1630x614				646x1809x686				756x2067x726				796x2262x844																			
Main Motor	3.7x4				3.7x4				3.7x4				5.5x4				5.5x4				7.5x4				7.5x4				11x4				11x4				15x4				15x4				18.5x4				18.5x4			
Slide Adjustment Motor	kWhP				kWhP				kWhP				kWhP				kWhP				kWhP				kWhP				kWhP				kWhP				kWhP				kWhP											
Foot Print (AvB)	720x1058				830x1125				890x1210				940x1315				1050x1480				1160x1680				1300x1985				1480x2113				1560x2400																			
Position of Anchor Bobs(MxN)	620x878				730x925				790x1010				840x1115				950x1230				1060x1380				1180x1655				1360x1753				1440x2000																			
Required Floor Space (WxL)	875x1360				985x1425				1035x1510				1085x1620				1195x1785				1310x1985				1510x2290				1690x2415				1770x2705																			
Press Height (w/o Mounts) (H)	2060				2185				2290				2540				2755				2990				3270				3725				4005																			
Required Air Pressure	0.5				0.5				0.5				0.5				0.5				0.5				0.5				0.5				0.5																			
Die Cushion (Option)	22				22				35				35				60				80				100				140				140				140				140											
Capacity	22				22				35				35				60				80				100				140				140				140				140											
Stroke Length	50				50				70				70				80				90				100				110				120				120				120											
Cushion Pad Area (LxRxF)	295x210				295x210				340x234				340x234				410x260				480x300				540x340				640x440				740x540				740x540															

Machine Dimension

SN1-160, 200, 250 are without shank holder

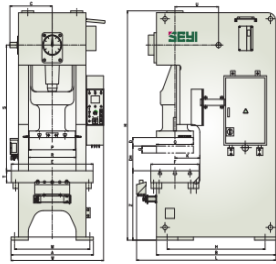

Dimension of Bolster Plate and Ram

The cushion pin holes of SN1- 25, 35, 45, 60, 200 are center located on bolster

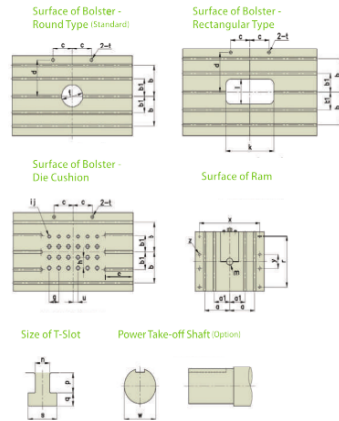

Model	SN1-25	SN1-35	SN1-45	SN1-60	SN1-80	SN1-110	SN1-160	SN1-200	SN1-250
a	105	130	140	150	160	180	260	300	350
a1	—	—	—	—	—	—	160	170	200
b	100	125	140	150	180	210	290	320	350
b1	—	—	—	—	—	—	165	180	200
c	130	130	150	150	150	150	200	200	250
d	135	170	185	200	250	300	340	380	410
e	185	210	220	240	270	280	290	320	320
f	ø100	ø110	ø130	ø150	ø180	ø200	ø220	ø250	ø270
g	65	65	75	75	75	90	100	100	100
h	60	90	100	100	75	90	100	100	100
i (LxRxF)	5x3	5x3	5x3	5x3	6x4	6x4	6x4	7x5	8x6
j	ø26	ø26	ø26	ø26	ø26	ø32	ø32	ø32	ø32
k	200	220	260	300	360	400	440	500	540
l	100	110	130	150	180	200	220	250	270
m	ø38.1	ø50.8	ø50.8	ø50.8	ø50.8	ø50.8	ø65	ø65	ø65
n	22	22	22	22	28	28	28	28	28
p	23	23	23	23	30	30	30	30	30
q	16	16	16	16	20	20	20	20	20
r	—	—	—	—	—	—	480	550	620
s	38	38	38	38	48	48	48	48	48
t	ø22	ø26	ø26	ø30	ø30	ø30	ø30	ø30	ø30
u	0	0	0	0	37.5	45	50	0	50
w	ø35	-0	ø35	-0	ø40	-0	ø40	-0	ø70
x	290	340	370	400	480	560	630	750	850
y	70	70	80	90	90	100	130	140	160
z	4-ø18	4-ø18	4-ø18	4-ø18	4-ø18	4-ø23	8-ø23	8-ø23	8-ø23

※ This specifications is subject to change without notice.

BOLSTER 台盤

Fig. 1 圖一

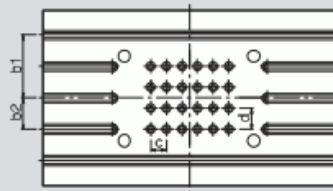

Fig. 2 圖二

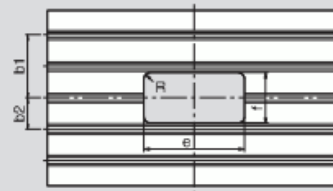

Fig. 3 圖三

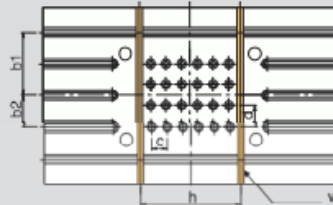
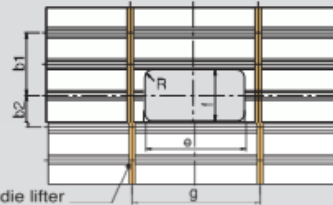

Fig. 4 圖四



with "U" slot for die lifter
含舉模器用"U"型溝

unit: mm

MODEL	機種	OCP-25	OCP-35	OCP-45	OCP-60	OCP-80	OCP-110	OCP-160	OCP-200	OCP-250
Type of T-Slot	T型槽型式	C	C	C	A	A	B	B	B	B
No. of T-Slot	T型槽條數	3	3	3	3	3	5	5	5	5
No. of Pin Hole x Dia.	模墊銷孔數目x孔徑	-	-	15 x $\varnothing 20^{+0.5}_{-0.1}$	15 x $\varnothing 20^{+0.5}_{-0.1}$	24 x $\varnothing 20^{+0.5}_{-0.1}$	24 x $\varnothing 20^{+0.5}_{-0.1}$	24 x $\varnothing 28^{+0.5}_{-0.1}$	35 x $\varnothing 28^{+0.5}_{-0.1}$	35 x $\varnothing 28^{+0.5}_{-0.1}$
c x d		-	-	75 x 85	75 x 100	75 x 75	90 x 90	100 x 100	100 x 100	100 x 100
b1		120	120	150	150	150	250	300	300	300
b2		-	-	-	-	-	150	150	150	150
e x f		260 x 130	280 x 140	300 x 150	320 x 160	360 x 180	400 x 200	440 x 220	480 x 240	520 x 250
R		20	20	20	20	30	30	30	30	30
g		400	400	420	420	480	480	520	560	580
h		-	-	360	370	440	530	580	680	700

SLIDE PLATE 滑塊板加工圖

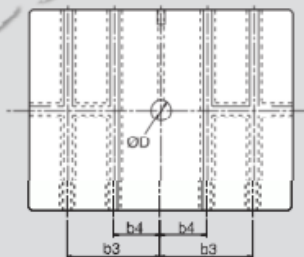

unit: mm

MODEL	機種	OCP-25	OCP-35	OCP-45	OCP-60	OCP-80	OCP-110	OCP-160	OCP-200	OCP-250
Slide Plate Area (LR x FB)	滑塊板面積 (左右x前後)	350x300	380x320	430x350	500x400	560x460	650x520	700x580	850x650	920x700
Type of T-Slot	T型槽型式	C	C	C	A	A	B	B	B	B
No. of T-Slot	T型槽條數	2	2	2	2	2	2	4	4	4
Shank Hole Dia. D	模柄孔徑	$\varnothing 38$	$\varnothing 38$	$\varnothing 38$	$\varnothing 50$	$\varnothing 50$	$\varnothing 50$	$\varnothing 65$	$\varnothing 65$	$\varnothing 65$
b3		100	100	125	125	150	150	300	300	300
b4		-	-	-	-	-	-	150	150	150

T-Slot Detail T型槽詳細

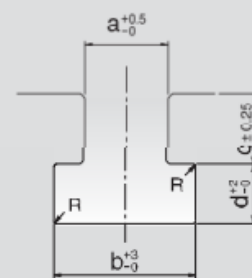

unit: mm

Dim. 尺寸	Type 型式	A	B	C
a		22	28	18
b		37	48	30
c		24	28	18
d		16	20	12
R		1	1	1

OUTLINE DIMENSIONS 外型尺寸

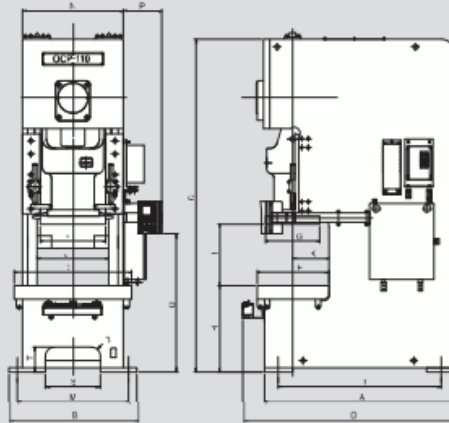

unit: mm

MODEL 機種	OCP-25			OCP-35			OCP-45			OCP-60			OCP-80			OCP-110			OCP-160			OCP-200			OCP-260					
	S	H	L	S	H	L	S	H	L	S	H	L	S	H	L	S	H	L	S	H	L	XL	S	H	L	XL	S	H	L	XL
A	1050			1190			1313	1358	1320	1382	1493	1565	1700.5	1770.5	1935	2000	2162.5	2225	2330	2430										
B	810			840			870			980			1120		1240		1360		1520	1590	1700	1800								
C	2070			2210			2305	2345	2500	2555	2805	2865	2965	3030	3385	3520	3755	3820	4205	4290	4380									
D	720			780			850			900			1000		1150		1250	1350	1400	1500	1500	1750								
E	320			340			360	440	400	520	460	600	520	680	600	760	680	820	700	900										
F	350			300			430			500			560		650		700		650		920									
G	300			320			350			400			460		520		580		650		700									
H	800	815	800	800	815	800	800	815	800	800	817.5	800	833	853	833	840	860	840	915	940	915	1010	1037.5	1010	1100	1140	1100			
I	315	285	330	330	295	345	330	300	390	360	325	440	400	360	490	430	390	530	80	430	350	700	560	505	650	700	640	560	750	840
J	478			502			510			534			598		660		750		850		910									
K	165			175			190	230	210	270	240	310	270	350	335	390		350		420		390		460						
L	830			960			1073	1118	1104	1166	1233	1305	1460.5	1530.5	1635	1700	1812.5	1875	1790	1890										
M	680			710			740			830			910		1050		1180		1320		1430		1470		1570					
N	600			630			660			700			800		950		1070		1190		1250		1050		1450					
O	1280			1420			1543	1588	1550	1612	1723	1795	1930.5	2000.5	2165	2230	2392.5	2455	2560	2660										
P	270			270			270			270			408		408		408		408		408		408		408					
Q	1180			1345			1335			1360	1370	1385	1440	1415	1480	1590	1460		1450		1380		1420							
R	80			80			40			40			50		100		100		100		100		100		100					
S	360			360			370			400			480		540		580		720		710									
T	340			343			300			500			283		280		265		285		330									

Standard Functions / Accessories

- Fixed Type Operation Stand
- E-Series Control System
 - Electronic Crank Angle Display
 - Electronic SPM Display
 - LCD type Press status monitor
- Operation Mode Selection
 - Off / Inching / Safety One Stroke / Continuous
- Hydraulic Overload Protector (H.O.L.P)
- Overrun Detector
- Door interlocking power isolation switch
- Dual-coiled Solenoid Valve
- Motorized Slide Adjustment (45-260 Ton)
- Die Height Indicator (Unit:0.1mm)
- Motorized Grease Lubrication Device
- Total Counter, 6 digits
- Preset Counter, 6 digits
- Maintenance Counter, 4 digits (Unit:10K)
- Life Counter 10 digits
- Electronic Rotary Cam Switch, 6 spare channel
 - Air Ejector, 3/8"
 - Air Source Receptacle, 3/8"
 - Misfeed Detection Concept

標準附屬品

- 固定式雙手按鈕操作台
- C電控
 - 電子式曲軸角度指示器
 - 電子式運轉速度指示器
 - 運轉狀態LCD監視器
- 運轉模式選擇
 - 切 / 寸動 / 安全一行程 / 連續
- 油壓過負荷保護裝置
- 二次保護保險裝置
- 空氣站/斷電開關
- 雙聯電磁閥
- 電能滑塊調整裝置 (45-260 Ton)
- 數字式模高指示器 (單位: 0.1mm)
- 電動黃油潤滑裝置
- 累計計數器6位數
- 預調計數器6位數
- 保養計數器4位數 (單位:萬)
- 壽命計數器10位數
- 電子式旋轉凸輪開關 預備6連
- 噴風裝置3/8"
- 空氣源接頭3/8"
- 誤送檢知插座

Optional Functions / Accessories

- Die Cushion
- VS Motor (Not Applicable to E-Series Control System)
- Control System MPC Series
- PLC Controller
- Photoelectric Safety Device
- Upper Slide Knockout Device
- Inverter & Main Motor Reversing Circuit Device
- Portable 2-hand Pushbutton T-stand
- Safety Block with plug
- Dual-coiled Solenoid Valve with Detector
- Load Monitor Device
- Flywheel Brake Device
- Power Receptacle (Single phase, 110V / 220V power source wiring by user)
- Power Take-off Shaft
 - Crankshaft Front-end Extension
 - Left-hand-side Frame Extension (Feed Direction: Left to Right)
- Quick Die Change System
- Foundation Anchor Bolts & Plates
- Anti-Vibration Press Mounts
- Die Area Light

特殊附屬品

- 模架裝置
- VS馬達 (非E電控使用)
- 沖床控制器MPC系列
- PLC可程式控制櫃
- 光電安全裝置
- 滑塊上部頂料裝置
- 變頻器與主馬達正逆轉裝置
- T型操作台
- 安全檯塊及安全插銷
- 附檢知誤繼電磁閥
- 荷重計
- 飛輪剎車裝置
- 電源插座110V或220V單相 (電源客戶自備)
- 送料軸端
 - 曲軸前端延伸式
 - 右身左側接出式 (送料方向: 左→右)
- 快速換模裝置 (O.D.C.S.)
- 基礎螺絲及基礎板
- 防震裝置
- 模具照像燈
- 電子式角度控制器

FEATURES



Auto Lubrication System

The auto lubrication system with default monitor ensures high reliable operation.



HMI Interface

User-friendly design for simple and easy operation.

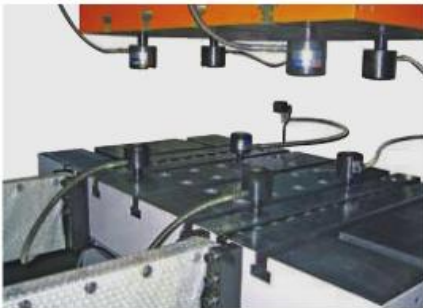

Quick Die Change Device (Option)

The die lifter, die clamp and auxiliary rails allow to carry out die changing easily in a short time.

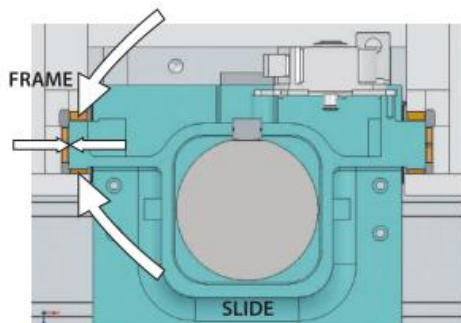

Long 6-Side Gibs

Durable alloy brone lining fixed directly on the frame without the defect of losing adjusting bolts. Durable lining can also maintain high accuracy and extend the life of tooling.

SN1 SERIES

Model	SN1-25			SN1-35			SN1-45			SN1-60			SN1-80			SN1-110			SN1-160			SN1-200			SN1-250					
	S	H	P	S	H	P	S	H	P	S	H	P	S	H	P	S	H	P	S	H	P	S	H	P	S	H	P	S	H	P
Capacity	250	350	450	450	600	800	1100	1500	2000	2500	3500	4500	6000	8000	11000	15000	20000	25000	35000	45000	60000	80000	110000	150000	200000	250000	350000	450000	600000	800000
Stroke Length (D)	80	50	35	90	60	40	110	70	45	130	80	50	150	100	60	180	110	70	200	130	80	220	150	90	250	180	100	250	180	100
Stroke per Minute	Fixed speed		Fixed speed		Fixed speed		Fixed speed		Fixed speed		Fixed speed		Fixed speed		Fixed speed		Fixed speed		Fixed speed		Fixed speed		Fixed speed		Fixed speed		Fixed speed			
	70-110	80-140	80-180	60-95	70-130	80-170	50-85	60-120	80-160	40-75	55-110	70-150	40-75	50-100	65-140	35-65	45-90	60-125	30-50	35-70	50-100	25-45	30-60	40-85	22-40	30-50	30-70	22-40	30-50	30-70
Tonnage Rating Point	3.2	2.3	3.2	2.3	3.2	2.3	3.2	2.3	3.2	2.3	3.2	2.3	3.2	2.3	3.2	2.3	3.2	2.3	3.2	2.3	3.2	2.3	3.2	2.3	3.2	2.3	3.2	2.3	3.2	2.3
Die Height (D.H)	230	200	200	250	220	220	270	240	240	300	270	270	330	300	300	350	320	320	400	360	360	450	400	400	450	400	400	450	400	400
Slide Adjustment (G)	50			50			60			70			80			90			100			110			120			120		
Slide Area (P&Z)	330x250			380x300			430x350			480x400			560x460			650x520			720x580			860x650			960x720			960x720		
Diameter of Shank Hole	ø38.1			ø50.8			ø50.8			ø50.8			ø50.8			ø50.8			ø65			ø65			ø65			ø65		
Bolster Area (E×F)	700x320			780x400			840x440			900x520			1050x600			1150x680			1250x760			1400x840			1500x900			1500x900		
Bolster Thickness (T)	85			100			115			130			140			155			165			180			180			180		
Bolster Height (Z)	800			800			800			900			900			900			900			1000			1000			1000		
Frame - Inside Distance (R)	388			486			516			544			614			670			730			900			970			970		
Frame - Gap Distance (K)	170			210			230			270			310			350			390			430			460			460		
PTD. Shaft Position (C×S×L)	351x983x383			403x1068x405			428x1158x437			450x1285x478			507x1445x512			596x1630x614			646x1809x686			756x2067x726			796x2262x844					
Main Motor	KW&P			KW&P			KW&P			KW&P			KW&P			KW&P			KW&P			KW&P			KW&P			KW&P		
Slide Adjustment Motor	KW&P			KW&P			KW&P			KW&P			KW&P			KW&P			KW&P			KW&P			KW&P			KW&P		
Foot Print (A×B)	720x1058			830x1125			940x1315			1050x1480			1160x1680			1300x1985			1480x2113			1560x2400			1560x2400			1560x2400		
Position of Anchor Bolt(M×N)	620x878			730x925			790x1010			840x1115			950x1230			1060x1380			1180x1655			1360x1753			1440x2000			1440x2000		
Required Floor Space (W×L)	875x1360			985x1425			1035x1510			1085x1620			1195x1785			1310x1985			1510x2290			1690x2415			1770x2705			1770x2705		
Press Height (w/o Mount) (H)	2060			2185			2290			2540			2755			2990			3270			3725			4005			4005		
Required Air Pressure	0.5			0.5			0.5			0.5			0.5			0.5			0.5			0.5			0.5			0.5		
Die Cushion (Option)	KW&P			KW&P			KW&P			KW&P			KW&P			KW&P			KW&P			KW&P			KW&P			KW&P		
Capacity	22	—	—	22	—	—	35	—	—	35	—	—	60	—	—	80	—	—	100	—	—	140	—	—	140	—	—	140	—	—
Stroke Length	50	—	—	50	—	—	70	—	—	70	—	—	80	—	—	90	—	—	100	—	—	110	—	—	120	—	—	120	—	—
Cushion Pad Area (L×R×FB)	295x210	—	—	295x210	—	—	340x234	—	—	340x234	—	—	410x260	—	—	480x300	—	—	540x340	—	—	640x440	—	—	740x540	—	—	740x540	—	—

Machine Dimension

SN1-160, 200, 250 are without shank holder

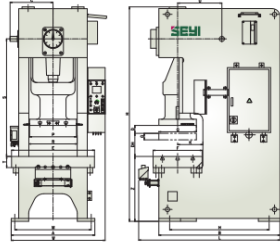

Dimension of Bolster Plate and Ram

The cushion pin holes of SN1-25, 35, 45, 60, 200 are center located on bolster

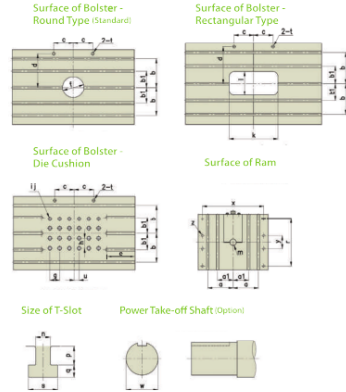

Model	SN1-25	SN1-35	SN1-45	SN1-60	SN1-80	SN1-110	SN1-160	SN1-200	SN1-250
a	105	130	140	150	160	180	260	300	350
a1	—	—	—	—	—	—	160	170	200
b	100	125	140	150	180	210	290	320	350
b1	—	—	—	—	—	—	165	180	200
c	130	130	150	150	150	150	200	200	250
d	135	170	185	200	250	300	340	380	410
e	185	210	220	240	270	280	290	320	320
f	ø100	ø110	ø130	ø150	ø180	ø200	ø220	ø250	ø270
g	65	65	75	75	75	90	100	100	100
h	60	90	100	100	75	90	100	100	100
i (L/R×FB)	5x3	5x3	5x3	5x3	6x4	6x4	6x4	7x5	8x6
j	ø26	ø26	ø26	ø26	ø26	ø32	ø32	ø32	ø32
k	200	220	260	300	350	400	440	500	540
l	100	110	130	150	180	200	220	250	270
m	ø38.1	ø50.8	ø50.8	ø50.8	ø50.8	ø50.8	ø65	ø65	ø65
n	22	22	22	22	28	28	28	28	28
o	23	23	23	23	30	30	30	30	30
p	16	16	16	16	20	20	20	20	20
q	—	—	—	—	—	—	480	550	620
r	38	38	38	38	48	48	48	48	48
s	—	—	—	—	—	—	—	—	—
t	ø22	ø26	ø26	ø30	ø30	ø30	ø30	ø30	ø30
u	0	0	0	0	37.5	45	50	0	50
w	ø35 -0	ø35 -0	ø40 -0	ø40 -0	ø40 -0	ø70 -0	ø70 -0	ø70 -0	ø70 -0
x	290	340	370	400	480	560	630	750	850
y	70	70	80	90	90	100	130	140	160
z	4-ø18	4-ø18	4-ø18	4-ø18	4-ø18	4-ø23	8-ø23	8-ø23	8-ø23

※ This specifications is subject to change without notice.

P.S.: The T-Slot on slide only for SN1-160 above.